



## Technical Features



RAL 9016  
standard



Stainless  
steel



Other colors  
on request



Range  
Up to 4,2 m



Airflow  
2920 - 5110 m<sup>3</sup>/h



Fans  
EC Double Inlet  
Centrifugal



Heating type  
Heat pump  
with sensors



Heating capacity  
15- 27 kW



Casing  
Galvanised Steel  
Self-Supporting



Grille type  
Rectangular perforated  
33x10



Outlet vanes  
Airfoil type  
Adjustable 0-15° each side



Control  
Slave DX  
(Optional Control Clever)

The INVISAIR air curtain is designed to be installed invisibly in false ceilings or drawers around the door. It is an ideal solution for those entrances that for architectural reasons require an air curtain installation that is fully integrated into the interior design of the building. Its energy saving heat pump compatible version achieves a reduction of up to 70% in consumption and CO<sub>2</sub> emissions (in heating mode).

Ready to connect to LG Inverter heat pump (R32/R410A) with direct expansion valve, not included, to be purchased by the customer. Includes Interface Kit DX PAHCMRA000 adapted by curtain and programmable control LG PREMTB001.

### Air curtain specifications

Model	Airflow m <sup>3</sup> /h	Fans Power	Fans Current	Outdoor unit	Outdoor unit	Gas-Liquid pipe connections	Noise Level (5 m)	Weight kg
		230V-50/60Hz kW	230V-50/60Hz A	230Vx1	400Vx3	inch	dB(A)	
IECG 1500 DX15-LG	2920	0,284	2,48	UUD1 U30	UUD3 U30	5/8" - 3/8"	62	69
IECG 2000 DX20-LG	4380	0,426	3,72	-	UU70W U34	1" - 3/8"	63	89
IECG 2000 DX22-LG	4380	0,426	3,72	-	UU70W U34	1" - 3/8"	63	89
IECG 2500 DX22-LG	5110	0,497	4,34	-	UU70W U34	1" - 3/8"	64	94
IECG 2500 DX27-LG	5110	0,497	4,34	-	UU85W U74	7/8" - 1/2"	64	94

### Outdoor unit specifications

LG inverter model Outdoor Unit	Heating capacity	COP or SCOP	Cooling capacity	EER or SEER	Voltage	Gas-liquid pipes	Minimum pipe length	Maximum pipe length	Maximum pipe height
	kW		kW			inch	m	m	m
UUD1 U30 (42)	13,5	4,5	12,1	7,4	230Vx1	5/8" - 3/8"	5	85	30
UUD1 U30 (48)	15,5	4,5	13,4	6,8	230Vx1	5/8" - 3/8"	5	85	30
UUD1 U30 (60)	17,5	4,5	15	6,6	230Vx1	5/8" - 3/8"	5	85	30
UUD3 U30 (36)	10,8	4,5	9,5	7,6	400Vx3	5/8" - 3/8"	5	85	30
UUD3 U30 (42)	13,5	4,5	12,1	7,4	400Vx3	5/8" - 3/8"	5	85	30
UUD3 U30 (48)	15,5	4,5	13,4	6,8	400Vx3	5/8" - 3/8"	5	85	30
UUD3 U30 (60)	17,5	4,5	15	6,6	400Vx3	5/8" - 3/8"	5	85	30
UU70W U34	22,4	3,5	19	2,84	400Vx3	1" - 3/8"	5	75	30
UU85W U74	27	3,25	23	2,81	400Vx3	7/8" - 1/2"	5	75	30



## Technical Features



RAL 9016  
standard



Stainless  
steel



Other colors  
on request



Range  
Up to 4,2 m



Airflow  
2920 - 5110 m<sup>3</sup>/h



Fans  
EC Double Inlet  
Centrifugal



Heating type  
Heat pump  
with sensors



Heating capacity  
15- 29 kW



Casing  
Galvanised Steel  
Self-Supporting



Grille type  
Rectangular perforated  
33x10



Outlet vanes  
Airfoil type  
Adjustable 0-15° each side



Control  
Slave DX  
(Optional Control Clever)

The INVISAIR air curtain is designed to be installed invisibly in false ceilings or drawers around the door. It is an ideal solution for those entrances that for architectural reasons require an air curtain installation that is fully integrated into the interior design of the building. Its energy saving heat pump compatible version achieves a reduction of up to 70% in consumption and CO2 emissions (in heating mode).

Ready to connect to LG VRF outdoor heat pump unit (R32/R410A) and expansion valve not included, the customer should purchase it. Requires LG VRF Interface KIT adapted for air curtain and programmable control, please consult.

Air curtain specifications

Model	Airflow m <sup>3</sup> /h	Fans Power	Fans Current	Expansion Valve	Gas-Liquid pipe connections inch	Noise Level (5 m) dB(A)	Weight kg
		230V-50/60Hz kW	230V-50/60Hz A				
IECG 1500 VRF15-LG	2920	0,284	2,48	PRLK048A0	5/8" - 3/8"	62	69
IECG 2000 VRF20-LG	4380	0,426	3,72	PRLK048A0	1" - 3/8"	63	89
IECG 2000 VRF24-LG	4380	0,426	3,72	PRLK048A0	1" - 3/8"	63	89
IECG 2500 VRF25-LG	5110	0,497	4,34	PRLK048A0	1" - 3/8"	64	94
IECG 2500 VRF29-LG	5110	0,497	4,34	PRLK048A0	7/8" - 1/2"	64	94

The VRF-compatible models are as follows:

- Multi V S
- Multi V 5
- Multi V IV



Selection program



## Dimensions

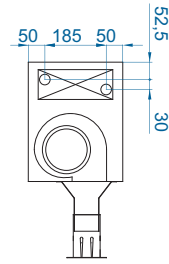
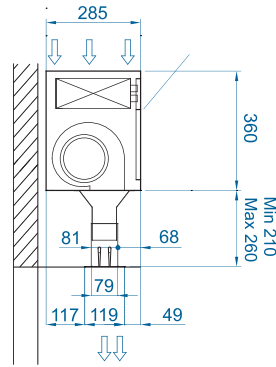
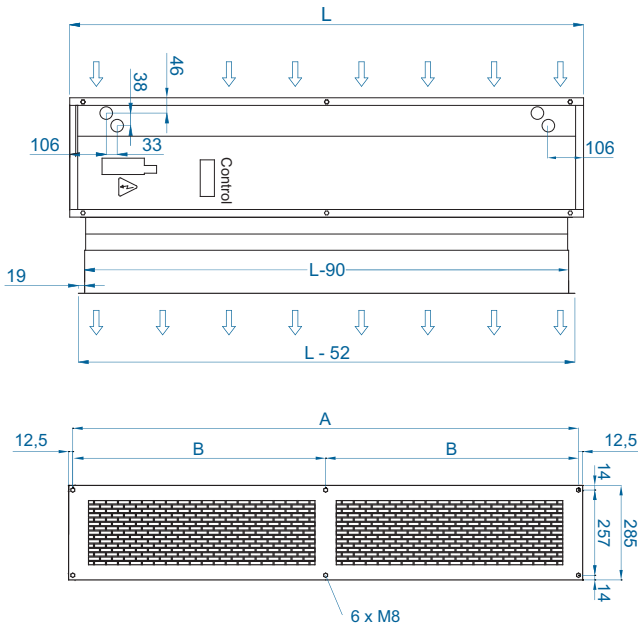

Model	L	A	B
1500	1550	1525	672,5
2000	2050	2030	1015
2500	2550	2530	1265

CAD drawings, BIM files, installation manuals and other documentation



## Accessories

### Supports



Wall rail support  
SPWR



Silentblock supports  
SPANG-SIL / SLB



Gripple hanger  
SPCT



Angle support  
SPWA



Slave DX  
(Included)



Interface kit  
IN-NE-II



Clever Control Kit



RJ45 Cable



External Temperature  
Sensor (Clever, TD-NE)

### Sensors



Magnetic door contact  
DC



Mechanical door contact  
DC